

Area 1-2
 AC Outage: 5/15/24 - 6/13/24
 Occupied: 5/15/24 - 6/13/24

Area: 1-0
 AC Outage: 5/15/24 - 6/13/24
 Occupied: 5/15/24 - 6/13/24

Area: 1-1
 AC Outage: 5/15/24 - 6/13/24
 Occupied: 5/15/24 - 5/21/24

Webster Hall
 LEVEL

Org Occupancy
 ■ MAVCAA
 ■ NON

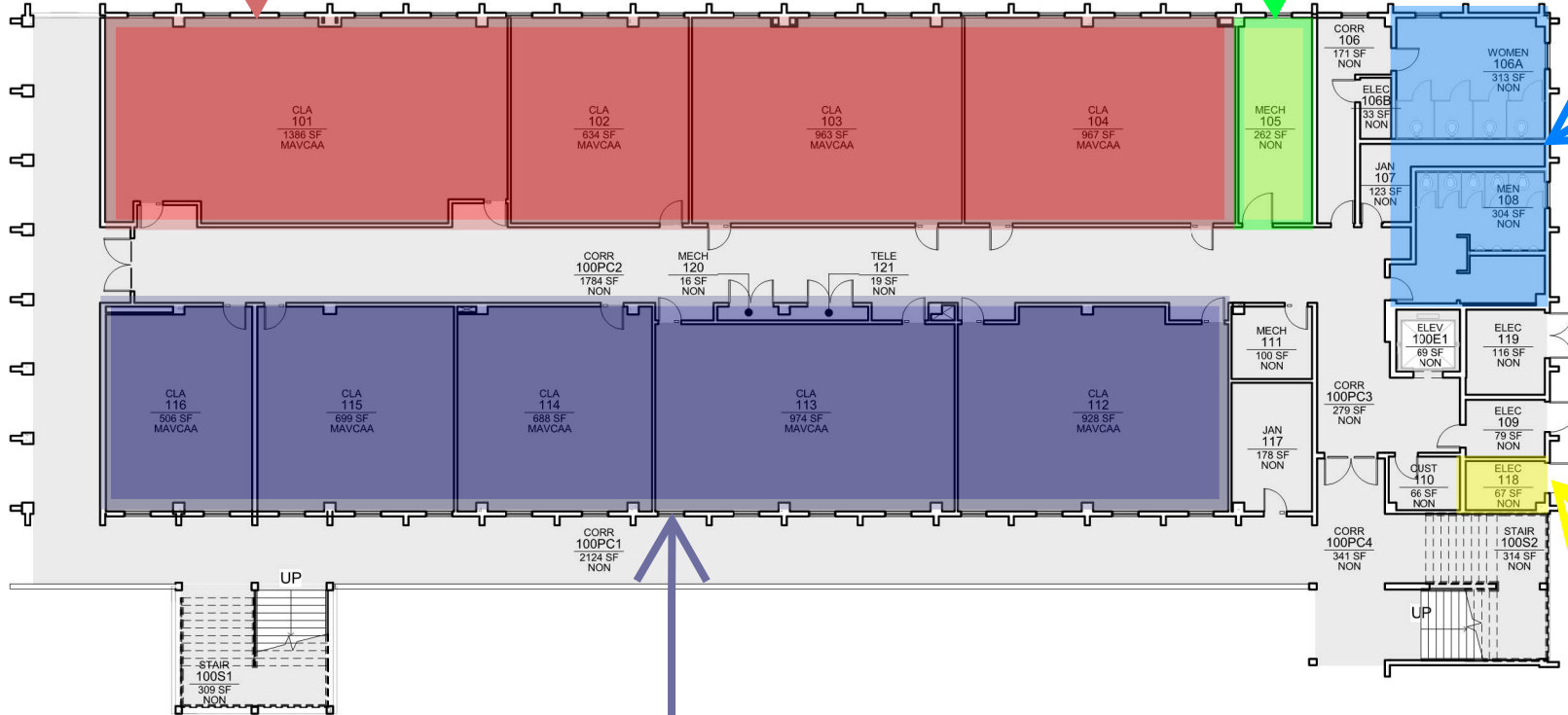

① 100 Level
 1/16" = 1'-0"

Area 1-2
 AC Outage: 5/15/24 - 6/13/24
 Occupied: 5/31/24 - 6/28/24

Area: 1-1
 AC Outage: 5/15/24 - 6/13/24
 Occupied: 5/22/24 - 5/24/24

PLN Space Inventory 100		
Department	Department Description	Area
Level 1		
MAVCAA	OFFICE OF THE VICE CHANCELLOR ACADEMIC AFFAIRS	7,746 SF
NON	NONASSIGNABLE	7,067 SF
Grand total		14,813 SF



Area 2-5
 AC Outage: 6/3/24 - 6/24/24
 Occupied: 6/3/24 - 6/9/24

Area 2-6
 AC Outage: 6/3/24 - 6/24/24
 Occupied: 6/10/24 - 6/16/24

Area: 2-2
 AC Outage: 7/1/24 - 7/28/24
 Occupied: 7/1/24 - 7/7/24

Area: 2-0
 AC Outage: 7/1/24 - 7/28/24
 Occupied: 7/1/24 - 7/28/24

Webster Hall
 LEVEL



Org Occupancy

- MAVCAA
- NON
- MANURS
- SWVPIT

① 200 Level
 1/16" = 1'-0"

Area: 2-4 (MECH 225)
 AC Outage: 6/3/24 - 6/24/24
 Occupied: 6/3/24 - 6/24/24

Area: 2-3
 AC Outage: 7/1/24 - 7/28/24
 Occupied: 7/8/24 - 7/14/24

Area: 2-1
 AC Outage: 7/1/24 - 7/28/24
 Occupied: 7/1/24 - 7/8/24

PLN Space Inventory 200		
Department	Department Description	Area
Level 2		
MANURS	NURSING	5,759 SF
MAVCAA	OFFICE OF THE VICE CHANCELLOR ACADEMIC AFFAIRS	1,625 SF
NON	NONASSIGNABLE	4,800 SF
SWVPIT	VP INFO TECH/CIO	1,279 SF
Grand total		13,464 SF



Webster Hall
LEVEL



Org Occupancy
 NON
 MAITND
 MANURS

Area: 3-1
AC Outage: 6/15/24

Area: 3-3
AC Outage: 6/15/24
Occupied: 6/17/24 - 6/21/24

Area: 3-0
AC Outage: 6/15/24

Area: 3-2
AC Outage: 6/3/24 - 6/7/24
Occupied: 6/3/24 - 6/7/24

① 300 Level
1/16" = 1'-0"



PLN Space Inventory 300		
Department	Department Description	Area
Level 3		
MAITND	MADNND - INFORMATION TECHNOLOGY	27 SF
MANURS	NURSING	7,752 SF
NON	NONASSIGNABLE	5,474 SF
Grand total		13,252 SF



Area: 4-5
 AC Outage: 6/10/24 - 6/30/24
 Occupied: 6/17/24 - 6/23/24

Area: 4-3
 AC Outage: 7/8/24 - 7/30/24
 Occupied: 7/15/24 - 7/21/24

Area: 4-6
 AC Outage - 7/8/24 - 7/30/24
 Occupied: 7/15/24 - 7/21/24

Webster Hall
 LEVEL

Org Occupancy
 ■ NON
 ■ MANURS

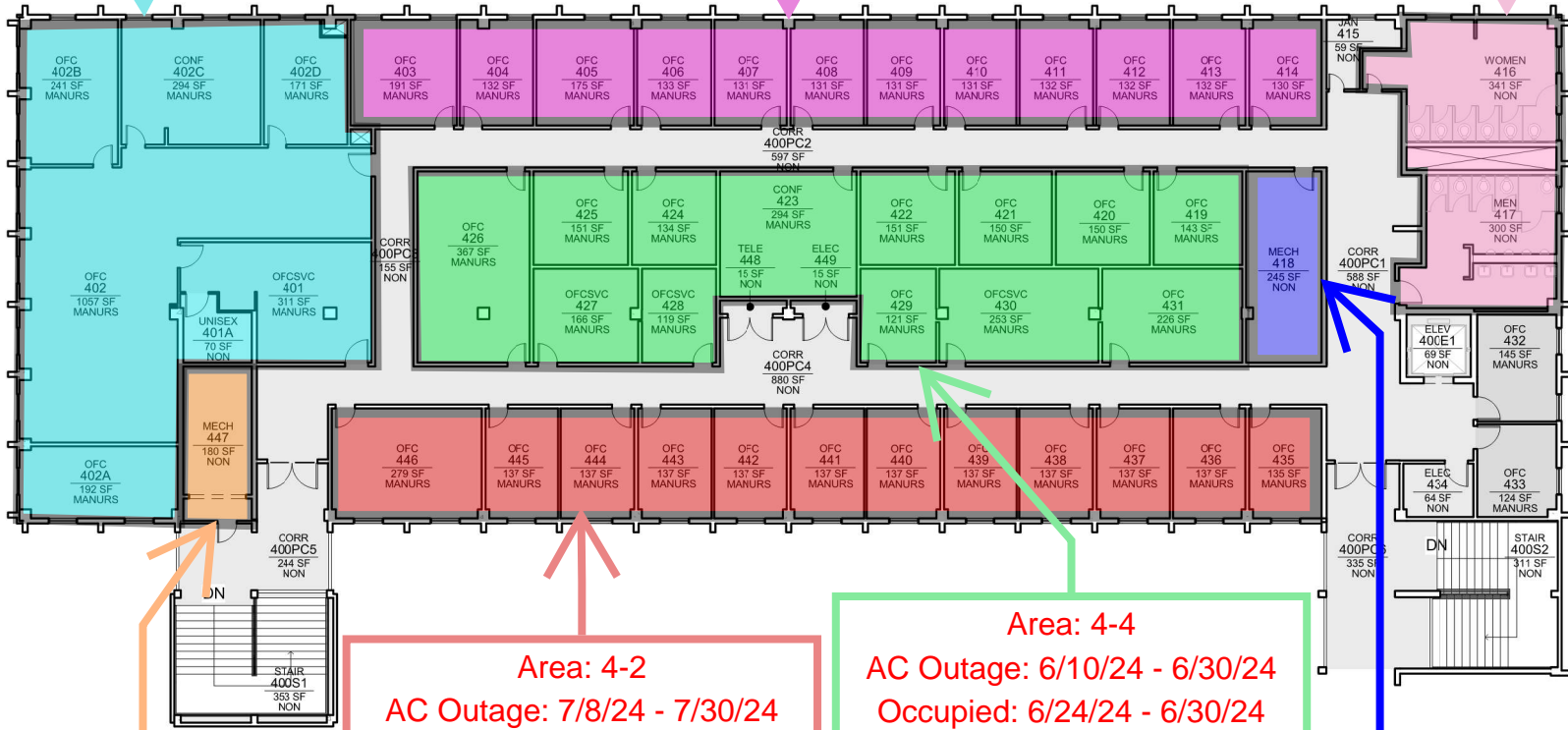

Area: 4-2
 AC Outage: 7/8/24 - 7/30/24
 Occupied: 7/22/24 - 7/28/24

Area: 4-4
 AC Outage: 6/10/24 - 6/30/24
 Occupied: 6/24/24 - 6/30/24

Area: 4-0
 AC Outage - 7/8/24 - 7/30/24
 Occupied: 7/8/24 - 7/30/24

Area: 4-1 (MECH 447)
 AC Outage: 6/10/24 - 6/30/24
 Occupied: 6/10/24 - 6/30/24

① 400 Level
 1/16" = 1'-0"

PLN Space Inventory 400		
Department	Department Description	Area
Level 4		
MANURS	NURSING	8,429 SF
NON	NONASSIGNABLE	4,822 SF
Grand total		13,251 SF



Webster Hall
LEVEL

Area: 5-0
AC Outage: 6/3/24 - 6/7/24
Occupied: 6/3/24 - 6/7/24

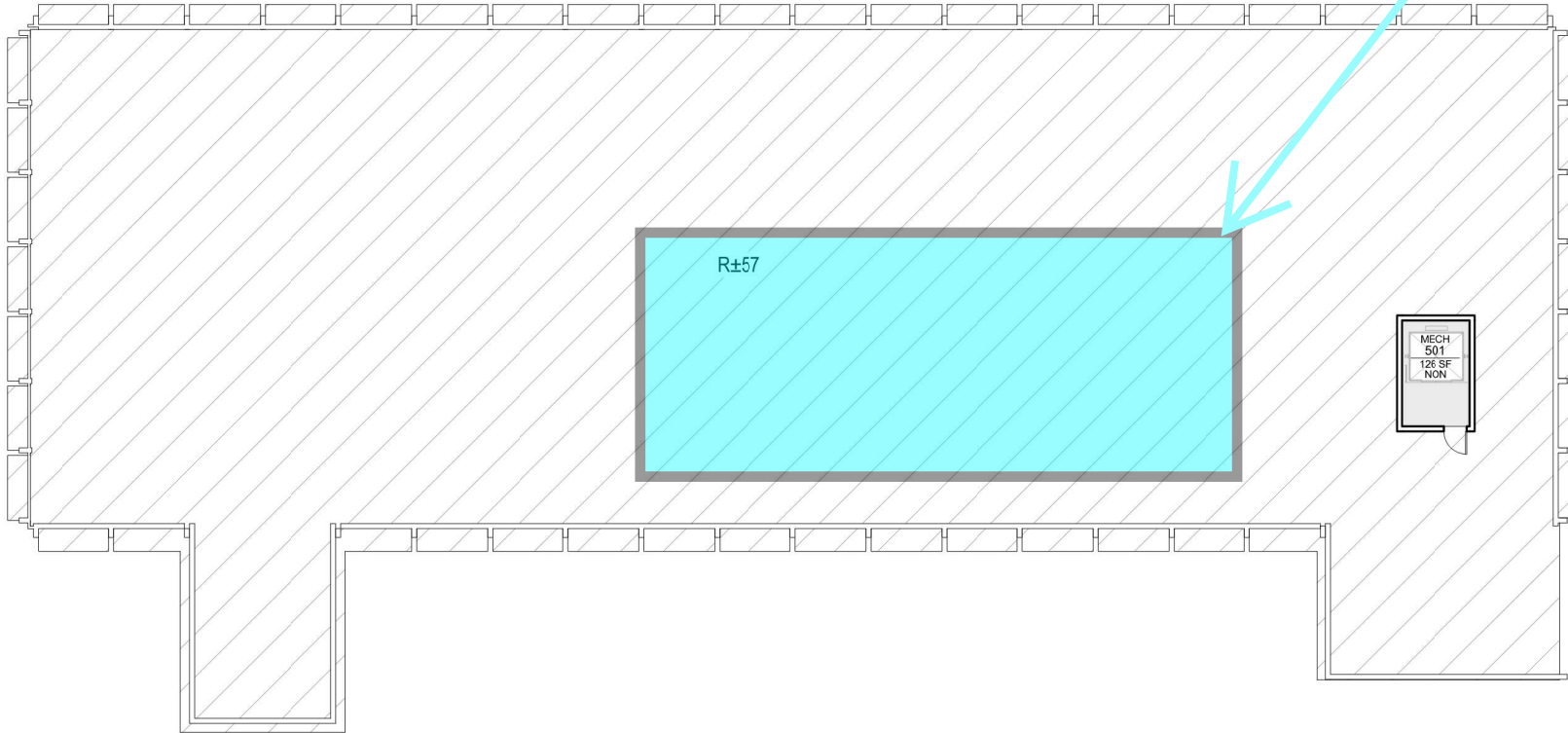

Org Occupancy
NON

① 500 Level
1/16" = 1'-0"

PLN Space Inventory 500		
Department	Department Description	Area
Level 5		
NON	NONASSIGNABLE	126 SF
Grand total		126 SF



University of Hawai'i at Manoa
UHPLANNING

Webster Hall 1167-LEVEL
Space Inventory Drawing 08/09/2016

1167-500